



# Easy and Effective Breast Imaging

Philips dStream Flex Breast coil solution for Ingenia 1.5T / 3.0T

An easy and effective solution for bilateral breast imaging. The solution comprises a dedicated, comfortable positioning mattress and two large flexible general-purpose coils. Combined with the FlexCoverage Posterior coil they allow bilateral coverage with a up to 8 channels. Patient positioning is simple, with a high level of patient comfort.

- Designed for bilateral breast imaging
- Supports routine diagnostics
- Soft mattress for comfortable breast imaging

**PHILIPS**  
sense **and** simplicity

# dS Flex Breast coil solution

Coverage	Bilateral
Max. number of channels	8
Main applications	Breast
Coil solution type	Dedicated
Coil connection	dStream Interface
SENSE parallel imaging	dS-SENSE enhanced parallel imaging performance

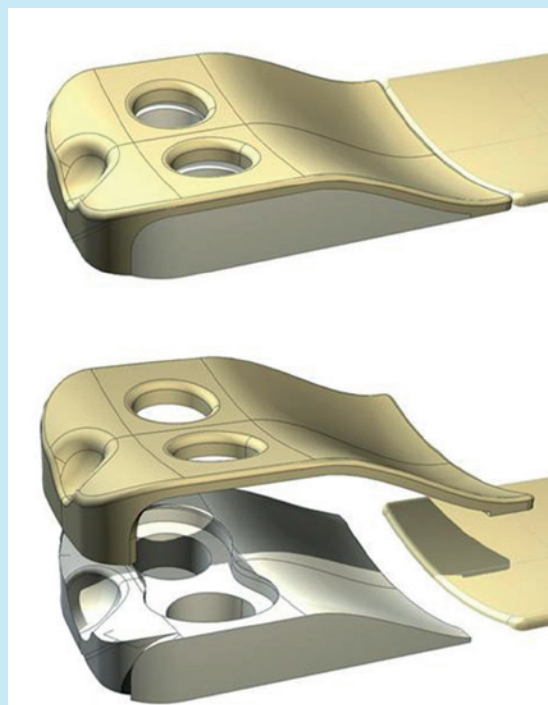

Please visit [www.philips.com/Ingenia](http://www.philips.com/Ingenia)



© 2011 Koninklijke Philips Electronics N.V.  
All rights are reserved.

Philips Healthcare reserves the right to make changes in specifications and/or to discontinue any product at any time without notice or obligation and will not be liable for any consequences resulting from the use of this publication.

Philips Healthcare is part of Royal Philips Electronics

[www.philips.com/healthcare](http://www.philips.com/healthcare)  
[healthcare@philips.com](mailto:healthcare@philips.com)

Printed in The Netherlands  
4522 962 70151 \* JAN 2011