





Philips Medical Systems / Product Recycling Passport

Product name:	17 in. TFT Touch
Identification code	M8033C
Total weight (in Kg)	7.25 kg
Producer /Manufacturer	Name company: Philips Medizin Systeme Boeblingen
	Address: Hewlett-Packard Strasse 2
	Zip code: Boeblingen 71034
	Country: Germany

Recycle info	Substances		Location	
 To be removed	Type	Quantity		
		Cd	0	
		Hg	Mercury is present in the backlight lamps (*)	Figure 1 (1)
		Pb	Lead is present in the soldering process of PCBs	Figure 1 (2)
		Cr ⁶⁺	0	
		PBB	0	
		PBDE	0	
		(*) Mercury is present in Backlight lamps: 20mg in total		

Batteries	Type	Quantity	Location
 To be removed	-	0	

Special attention	Item	Location
	-	

Fluids / Gases	Item	Location
	-	

Philips Medical Systems / Product Recycling Passport

Locations as mentioned in the Passport (Pictures information)

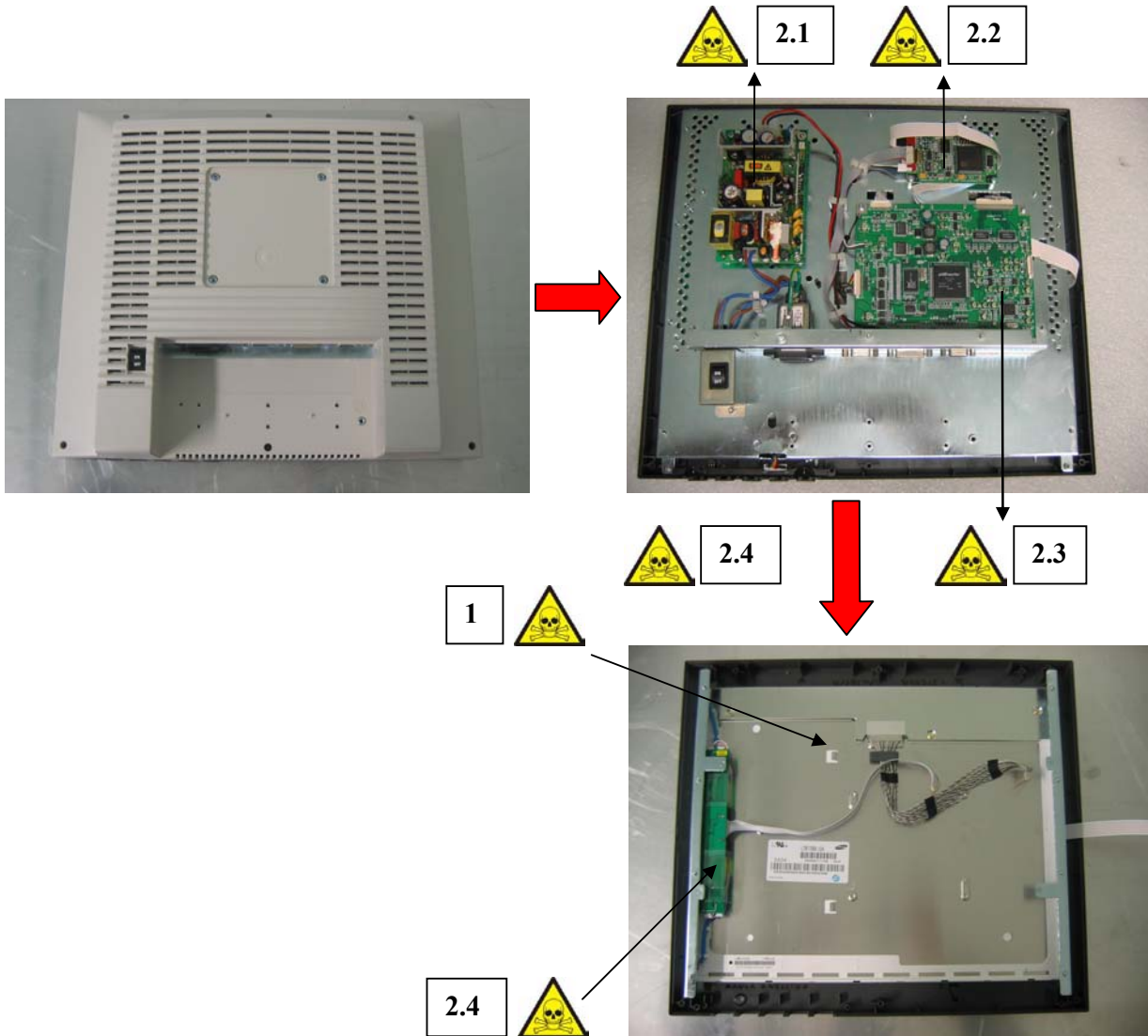

Material		
Fe	2.5 kg	-
Al	0.2 kg	-
Cu	0.11 kg	Cables
Plastics	1.2 kg	-
Boards (S² > 10cm²)	98 cm ² / 130 g 45 cm ² / 30 g 201 cm ² / 140 g 15 cm ² / 10 g 40 cm ² / 40 g	S.M.P.S. (item 2.1 in the picture) Touch-screen Board (item 2.2 in the picture) Logic Board (item 2.3 in the picture) Keyboard (item 2.4 in the picture) Inverter (item 2.4 in the picture)
LCD	2.1 kg or 1.7 kg	17" Color. models: LTM170E6-L04 or LTM170E8-L01